

- diagonal impeller with stator
- Plastic housing
- 3-step or speed controllable
- integrated thermal switch
- including mounting bracket

230V 50Hz

Operating Point			1	2	3	4	5
Current	I	A	n. def.	0.21	0.22	0.22	n. def.
Power Consumption	P ₁	W	n. def.	46	50	50	n. def.
RPM	n	1/min	n. def.	2810	2750	2740	n. def.
SPL inlet	L _{WA5} dB (A)						
SPL outlet	L _{WA6} dB (A)						
SPL casing break out	L _{WA2} dB (A)						
Voltage	U _N	230V ~	Speed Control			3-2-1	
Current	I _N	0.2 A	Motor Protection			TAI	
Current	I _{max}	0.2 A	Capacitor			2 µF / 450 V	
Ambient Temperature	t _U	80 °C	Isolation Class			F	
Medium Temperature	t _F	80 °C	Poles			2	
			Weight			0 kg	

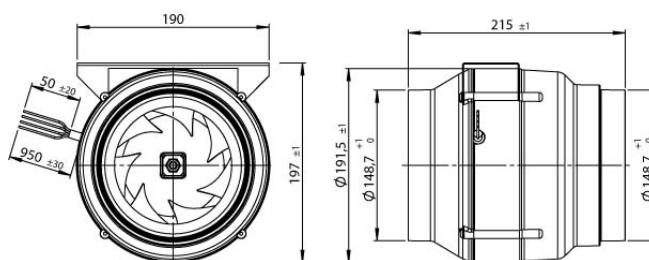
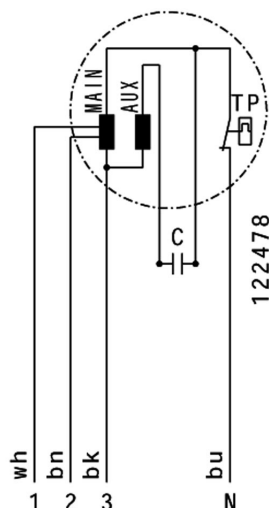

Accessories for EL 150 E2M 01

For more information see internet



TEE 015

5-Step Transformer

Without motor protection



TES 0145

7-Step Transformer
without motor protection



GS 03

Isolator Switch



VM 150

Fast Clamps
for noise reduction and sealing



RSK 150

Back Draught Shutter



RSK 150D

Back Draught Shutter
with seal



SG 150 01

Protection Grille



SDS 150

Duct Silencer, rigid



SDF 150

Duct Silencer, flexible



EV 150

Filter Box with Mat Filter G3



FT 150

Filter Box for Bag Filter



FTW 150

Filter Box with Bag Filter F5
Integrated heating coil